

VAD Standard Operating Procedure

Centurion Driveline Dressing

Effective Date October 2019
Approval Date October 2019
Supersedes November 2018

I. **Purpose:**

To maintain a sterile dressing to the Ventricular Assist Device (VAD) driveline site to reduce the possibility of infection.

II. **Considerations:**

It is the policy of the Vanderbilt Mechanical Assist Program that the nurse caring for the patient with a VAD be deemed competent of performing a driveline dressing change, per this protocol, by a VAD care team member, VAD specific super user, or VAD unit educator with a completed competency check off.







III. **Supplies Needed:**

- A. 1 – Centurion VAD Driveline Management kit;
- B. 1 – Mask for each person in the room; and
- C. 1 – Pack sterile 2x2 drain sponge if applicable.

IV. **Set Up:**

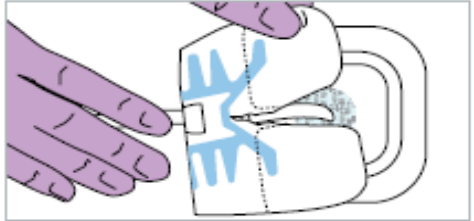
- A. Elevate bed to comfortable height;
- B. Move waste basket close to bed/table/patient;
- C. Remove patient's abdominal binder;
- D. Remove hand and wrist jewelry; and
- E. Perform routine hand hygiene with soap and water or with alcohol-based hand sanitizer.

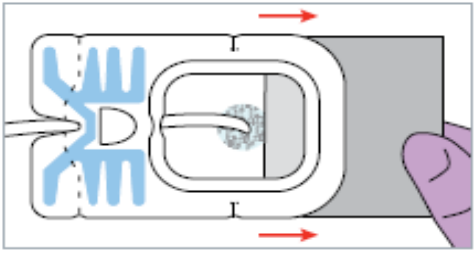
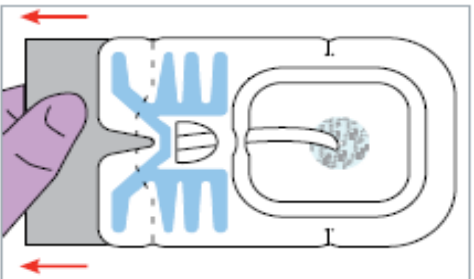
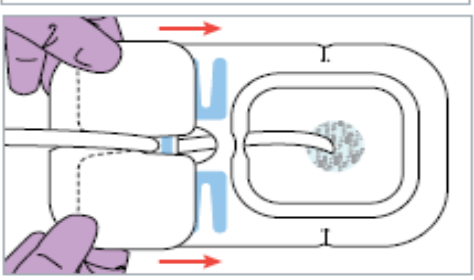
VI. Dressing Change:

<p>1. Wipe work area down with alcohol or approved cleaning substitute</p>	
<p>2. Open the external packaging of the driveline management system kit. Take care to maintain the sterility of the inside contents.</p>	 
<p>3. Put mask on patient, yourself, and anyone else in the room.</p>	
<p>4. Put on first set of gloves in the package.</p>	
<p>5. Remove old dressing and release driveline from anchor.</p>	
<p>6. Examine driveline exit site and surrounding skin.</p>	
<p>7. Clean hands with soap and water or alcohol-based hand sanitizer.</p>	
<p>8. Put on sterile gloves.</p>	
<p>9. With the first Chloraprep® applicator gently work from exit site outward, well beyond entire dressing site and up the driveline one time without tugging on the driveline.</p>	
<p>10. Allow Chloraprep® to dry on skin completely – Approximately 30 seconds up to 2 minutes.</p>	
<p>11. Repeat process using second Chloraprep® applicator.</p>	
<p>12. Allow Chloraprep® to dry on skin completely – Approximately 30 seconds up to 2 minutes.</p>	
<p>13. Place sterile 2x2 drain sponge around driveline if needed/ordered.</p>	
<p>14. Apply dressing to site:</p> <ul style="list-style-type: none"> • Partially remove first liner. • Position dressing with insertion site in the middle of the clear window. • Remove second liner. • Pinch/press dressing around 	

<p>driveline during application to create seal.</p> <ul style="list-style-type: none"> • Apply closure piece under driveline and over the edge of dressing. 	
<p>15. Remove mask and sterile gloves.</p>	
<p>16. Sign, date, and initial.</p>	
<p>17. Secure driveline using enclosed Centurion Foley Anchor.</p> <ul style="list-style-type: none"> • OPTIONAL: Apply enclosed skin protectant and allow to dry. • Position anchor under driveline at desired location. (A) • Holding driveline in place, locate arrow on base of device. Pull up tab. (B) • Locate second tab across from arrow and pull up tab to expose slit. (B) • Using tab on the same side as arrow, push tab thru slit. (B) • Grasping both tabs, pull them in opposite direction until the first tab pulls completely through the slit and the tabs lock into place. (C) • While holding the driveline in place, peel off one side of paper backing and press anchor into place. Repeat on other side to secure device. (D) 	

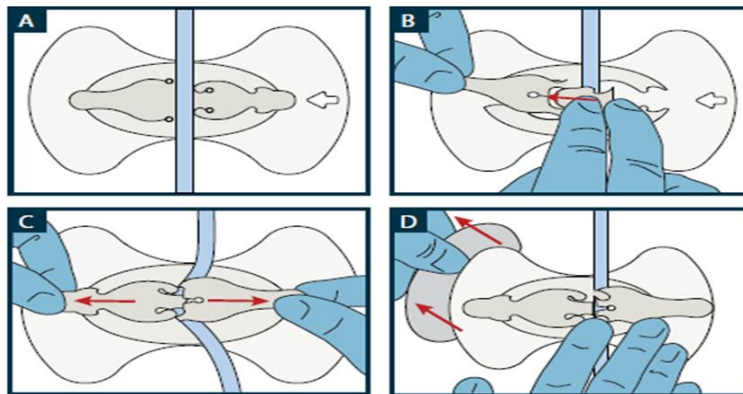

VII. Approval:

Ashish Shah, MD 10/11/19
 Professor of Cardiac Surgery, Alfred Blalock Endowed Director and Chairman,
 Department of Cardiac Surgery

Sandip Zalawadiya, MD 10/11/19
 Assistant Professor of Medicine
 Medical Director, Ventricular Assist Device Program

VIII. References:

Centurion Medical Products Educational Department; www.centurionmp.com