

# RAD Studio - Department of Radiology

RAD Studio is located at MCN D1101, rooms D1101C-E.

D1101C: Communications & Design Team office

D1101D: Makerspace & Design Thinking

D1101E: Ideation & Meeting Space\*

\*D1101E is located inside D1101D.

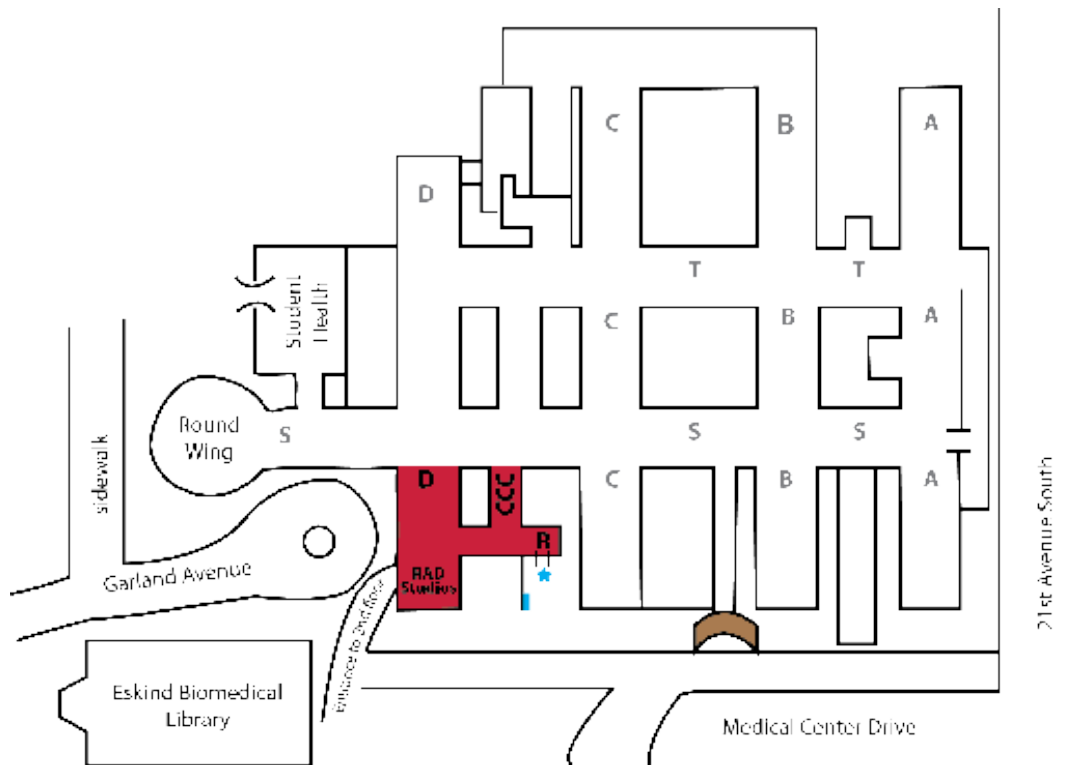

## Directions from coffee shop on 2nd floor:

- Take stairs located next to the refrigerators
- Go down one floor
- Turn right
- Walk through the open doorway
- RAD Studios is located on the left
- Enter through the glass door (second door on left)

## Directions from Medical Center Drive:★

- Walk towards the doorway with the brown awning
- Turn left and walk towards the blue sign that says "Department of Radiology and Radiological Sciences."
- Turn right and go through double doors
- Follow the hallway to the left
- Continue down the hallway and turn left
- Walk through the open doorway at the end of the hallway
- RAD Studios is located on the left
- Enter through the glass door (second door on left)